

# €3,460,000

Ref: PP175921

Introducing the most exceptional penthouse on Madeira Island - a masterpiece of luxury and location, located in the prestigious Madeira Acqua development, directly on the oceanfront in Funchal. This...

- Pool
- A/C
- Garden

Telephone: +351 213 471 603  
Email: [info@portugalhomes.com](mailto:info@portugalhomes.com)

Praça da Alegria 1, 3rd Floor, 1250-004 Lisboa, Portugal Licence AMI - 14414 | APEMIP 5940



## Property Description

Introducing the most exceptional penthouse on Madeira Island - a masterpiece of luxury and location, located in the prestigious Madeira Acqua development, directly on the oceanfront in Funchal.

This brand-new, never-before-used apartment offers a breathtaking open-concept living room facing the sea, a fully equipped designer kitchen, a social bathroom, and a laundry area.

The master suite redefines elegance with a freestanding bathtub, double vanity, walk-in closet, and a separate toilet and shower with a stunning glass skylight - all with direct access to a private terrace featuring your very own pool with panoramic Atlantic views.

The terrace is a true sanctuary: vast, private, and offering uninterrupted, jaw-dropping views of the ocean horizon. There is nothing in front of you but sky, light, and sea.

The condominium offers a serene, resort-style lifestyle with a shared pool, expansive landscaped gardens, a gym, and an exclusive private elevator for owners with direct access to the beach.

Additional features include a private storage unit on the same level as the apartment, 2 outdoor parking spaces, and 4 underground, a rare convenience.

This is not just a property, it's the pinnacle of coastal living in Madeira.



## Gallery

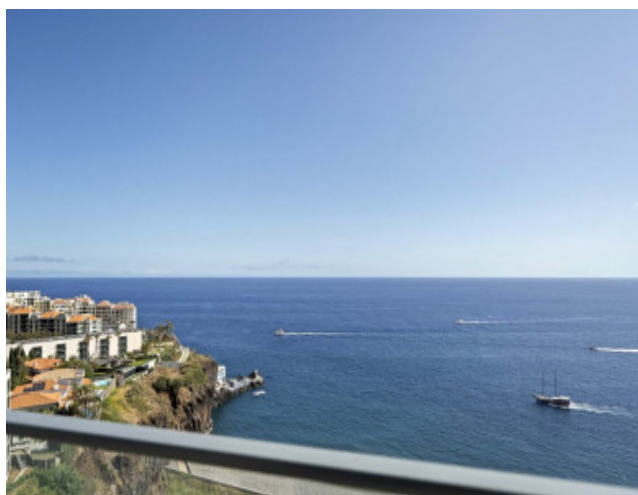
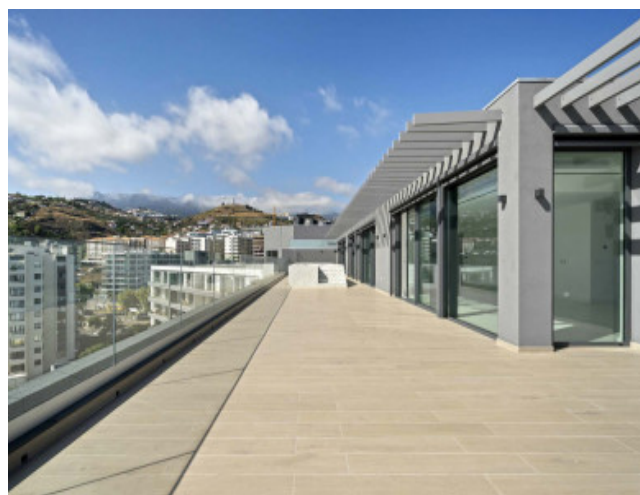
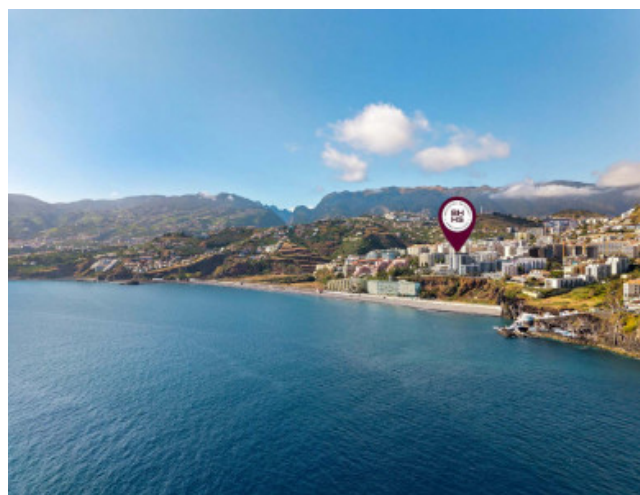
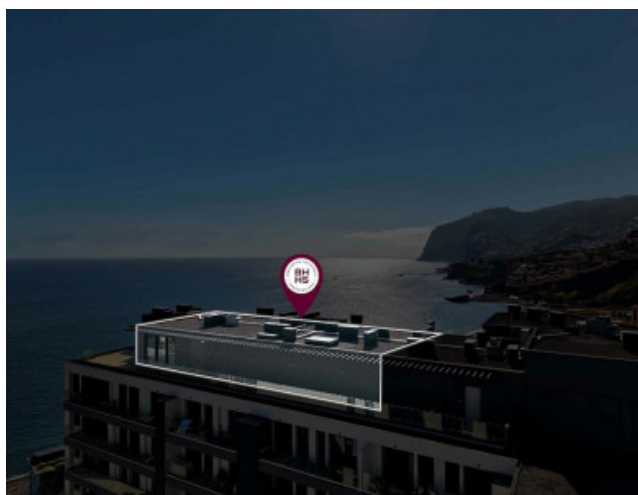
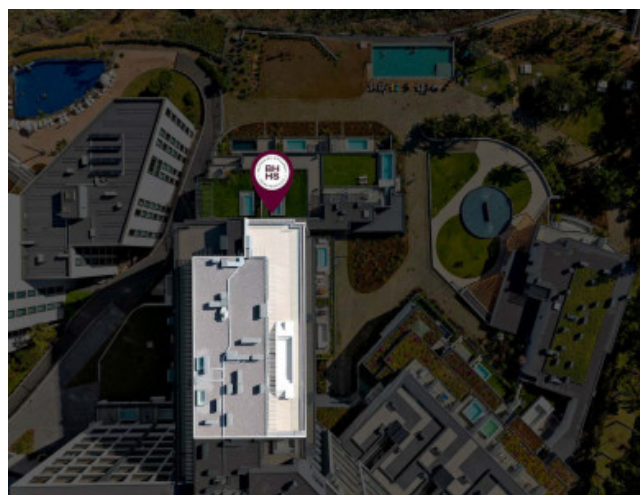
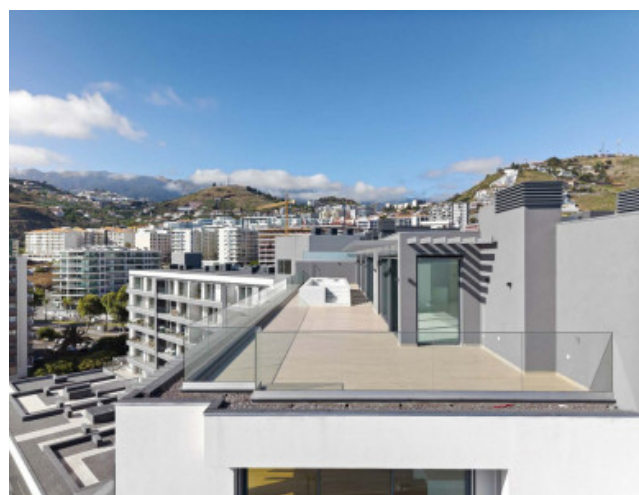

Telephone: +351 213 471 603  
Email: [info@portugalhomes.com](mailto:info@portugalhomes.com)

Praça da Alegria 1, 3rd Floor, 1250-004 Lisboa, Portugal Licence AMI - 14414 | APEMIP 5940

## Additional Details

Attributes

Status	Gross Area	Year Built
Available	302sq m	2024

Property Features

Pool	A/C	Garden
------	-----	--------

# Site Floorplan