

€900,000

Ref: PP3839

Modern brand new four bedroom, five bathroom townhouse in a great location. Set in an L-shaped private condominium with 15 townhouses, enjoying underground garage and storage. Beautiful...

- Pool
- A/C
- Garden

Telephone: +351 213 471 603
Email: info@portugalhomes.com

Praça da Alegria 1, 3rd Floor, 1250-004 Lisboa, Portugal Licence AMI - 14414 | APEMIP 5940



Property Description

Modern brand new four bedroom, five bathroom townhouse in a great location.

Set in an L-shaped private condominium with 15 townhouses, enjoying underground garage and storage.

Beautiful sea views from each property and each one will have its private entrance and private swimming pool.

Modern and elegant design, each room is spacious and bright, with marble and inox staircases.

From the ground floor, there is access to the storage room and the large private garage which has an electric door.

The modern fitted kitchen comes fully equipped, large dining/living room opening to the patio and the private pool.

One ensuite bedroom and one fitted bathroom downstairs and three en suites on the first floor.

The four bedrooms come with a fitted wardrobe and sliding doors.

Air conditioning in each room, solar panels for each property and central vacuum system.

Now completed, this excellent townhouse comes with a 2000m2 private plot of land, where there will be built a summer kitchen to enjoy the Algarvian outdoor living.

This lovely condominium is close to all amenities, bars and restaurants, schools, golf and beaches.

Faro International Airport is 30 minutes away.

Ideal property for long term living or holiday rentals

Gallery

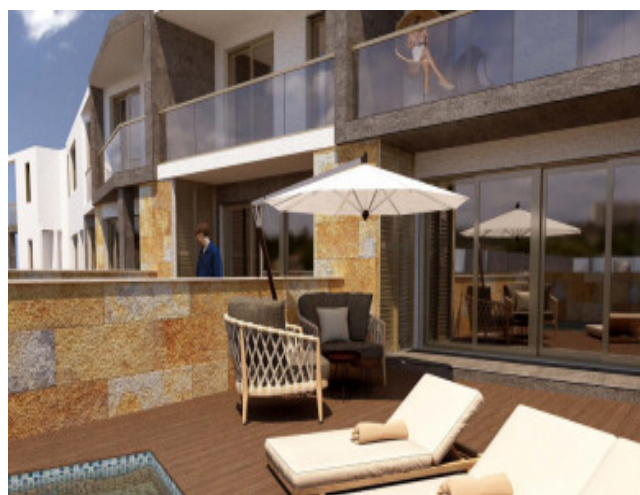

Telephone: +351 213 471 603
Email: info@portugalhomes.com

Praça da Alegria 1, 3rd Floor, 1250-004 Lisboa, Portugal Licence AMI - 14414 | APEMIP 5940

Additional Details

Attributes

Status Available	Gross Area 200sq m	Year Built 2020
----------------------------	------------------------------	---------------------------

Property Features

Pool	A/C	Garden
------	-----	--------

Site Floorplan